

CASIO IT-600

General Guide / Options



Li-ION battery standard HA-D20BAT	Cradle (communication and charging) HA-D60IO	Cradle type charger HA-D30CHG	Scan head (downward) HA-D50BN															
Li-ION battery large HA-D21LBAT	AC adaptor AD-S42120AE	AC adaptor AD-S15050AE	Model selection															
Dual battery charger HA-D32DCHG	<table border="1"> <thead> <tr> <th>Model</th> <th>WLAN</th> <th>Camera</th> </tr> </thead> <tbody> <tr> <td>IT-600M30</td> <td>No</td> <td>No</td> </tr> <tr> <td>IT-600M30C</td> <td>No</td> <td>Yes</td> </tr> <tr> <td>IT-600M30R</td> <td>Yes</td> <td>No</td> </tr> <tr> <td>IT-600M30CR</td> <td>Yes</td> <td>Yes</td> </tr> </tbody> </table>			Model	WLAN	Camera	IT-600M30	No	No	IT-600M30C	No	Yes	IT-600M30R	Yes	No	IT-600M30CR	Yes	Yes
Model	WLAN	Camera																
IT-600M30	No	No																
IT-600M30C	No	Yes																
IT-600M30R	Yes	No																
IT-600M30CR	Yes	Yes																

Specifications

		IT-600M30	IT-600 M30C	IT-600 M30R	IT-600 M30CR
CPU	Intel®PXA270 processor (520 MHz)				
OS	Microsoft® Windows® CE 5.0 (english version)				
Memory					
RAM	64 MB				
F-ROM	128MB (approx. 60 MB user area)				
Scanner					
Device	Laserscanner				
Resolution	0,127mm				
Distance	40-300mm or. 0-200mm with optional nose cap				
Readable codes	UPC-A/E, EAN/JAN, NW-7, ITF, CODE39, MSI, Industrial 2 of 5, CODE93, CODE128, IATA, EAN128, RSS14, RSS Limited, RSS Expanded				
Display					
Casio-Super-LCD	Transfektive 16-bit-TFT, colour touch display				
Size / Pixel	3,7", resolution: 480 x 640 (VGA) and 240 x 320 dots				
Font size	Scalable fonts				
Back light	ruggedized LED technology				
Key pad	21 keys, 3 scanner keys (left, center, right) Additional On screen keypad				
Interfaces	Bluetooth® version 1.2 IrDA 1.3 compatibel (max. 4Mbps) USB version 1.1 (client and host)				
Wireless LAN	Standard	-	-	IEEE802.11b/g	
Digital camera	CCD sensor	-	1 mio. pixel	-	1 mio. pixel
Power	Type	Li-Ion-battery: standard (1.850mAh) / large (3.700mAh)			
Operating period		Standard: approx. 11 hours		Standard: approx. 10 hours	
Memory back-up		Large: approx. 22 hours		Large: approx. 20 hours	
		Integrated rechargeable Li-Ion battery			
Audio		Speaker (monaural), Microphone (monaural), Headphone jack			
Buzzer		Yes			
Vibration		Built-in			
Dimension (LxWxH)		Approx. 166 x 82 x 23 mm			
Weight		Approx. 290g (with standard battery)			
Environment					
Drop durability		1.2 m			
Dust/water splashproof		IP54			
Operating temperature		-10° to +50°C			



Windows® and Windows® CE® are registered trademarks of the Microsoft Corporation, USA. The Bluetooth trademark is owned by Bluetooth SIG, USA and licensed to Casio Computer Co. Ltd.. Other product- or company names are either trademarks or registered trademarks of the respective owners. This publication carries product description without obligation and is not to be seen as a firm offer. Specifications and design are subject to change without notice.

CASIO®

CASIO Europe GmbH · Mobile Industrial Solutions · Bornbarch 10 · 22848 Norderstedt
Tel.: +49 (0)40 52 86 5-407 · Fax: +49 (0)40 52 86 5-424 · E-Mail: solutions@casio.de www.casio-europe.com

The new generation Industry-PDA. For efficient mobile Information Management.



- Drop tested from 1.2 m to concrete, sealed to IP54
- 3.7" TFT Touchscreen LCD, ideal for indoor and outdoor use
- Various industrial standard interfaces
- Up to 22 hours of continuous use
- Microsoft® Windows CE® 5.0

CASIO®

Efficient data handling with a maximum of possibilities



The small but powerful IT-600 enables a variety of new possible solutions in mobile data communication. Originally created for the retail industry this data terminal is well suited to generate, process and transfer all sorts of relevant store operations information. With these possibilities the IT-600 enables the store management to quickly react to fast changing sales situations.

Whether you take the quality of the brilliant display, the broad communication ability, the high level of dust and water-splash proof and drop resistance or the long operating times: The IT-600 provides the highest performance with almost every single feature it offers. Performance that is welcome in the retail industry as well as in many other possible sectors where the IT-600 can be used in highly efficient mobile information management solutions.

Rugged and reliable: withstands the harshest handling and environments

Whether at goods entry, in the warehouse or directly at the shelves – a mobile data terminal used in the retail business has to withstand rough handling and severe environments. The IT-600 is water splash proofed and dust proofed according to level IP54 (IEC60529-Standard). So usage in wet and dirty environments or outdoors is not a problem. Rough handling is part of the business. The IT-600 is built to resist a drop from 1.2 metres onto concrete without any problems and it does survive almost every sort of harsh treatment that may occur in various areas of enterprise.

Quick and unflinching: high-performance barcode reader



The scanning of barcodes has to happen quickly and reliably. Even with dirty and damaged barcode tags. The high-performance barcode reader of the IT-600 delivers successful scans under all circumstances. An automatic control function for the laser reading width enables also the successful reading of codes that are close to each other. Successful scans can be confirmed via LED, buzzer or vibration. The terminal can comfortably be held singlehanded for scanning as there are three scanning keys available. By using an optional scan head the laser is angled downwards instead of scanning to the front.

Ready for communication: with high speed WLAN and Bluetooth™



The built-in wireless LAN module (R- and CR-models only) enables safe high-speed and real-time communication in either the 802.11b or 802.11g standard with data transfer rates of up to 54 mbps. So an upcoming upgrade of existing WLAN networks will be no problem with using the IT-600.

In Wireless standby modus the device needs only very little power while it is able to receive messages at all times. To go back from stand-by into normal operation mode it only needs a few seconds.

With the integrated Bluetooth module external devices such as mobile tag printers can be used quickly and easily and without cable connections – perfectly used for price labelling or printing

warehouse tags. With the optional card slot GPRS, LAN or storage cards can be used. A built-in Mini-SD slot inside the battery compartment offers additional storage capacity.

Power pure: with up to 22 hours of continuous use.

The Li-Ion battery pack stores 1850 mAh (standard) or 3700 mAh (large). Thanks to high-level power management the large battery pack enables a continuous use of approx. 20 hours without recharging and including active WLAN connections. Without WLAN connections the device can be used 22 hours continuously.

In the case of a complete battery exhaustion, program error or other malfunction, the auto recovery tool allows the previously used application to be backed up without the know-how of a system administrator being needed.

3.7" VGA display with superb visibility whether in darkness or bright sunlight.

The 3.7" transfective TFT colour LDC displays sharp and easy to read pictures whether in bright sunlight or in total darkness. The display shows full VGA resolution with 640 x 480 dots compared to standard 1/4-VGA displays. This means a four times higher resolution. So even the smallest details can be viewed. In order to be able to use the existing 1/4-VGA-software solutions with the IT-600 the display can also show 240 x 320 QVGA resolution.

With landscape mode the screen can be turned by 90° in order to view web-based files or other applications that can better be viewed in a broader format. The backlight uses LED technology with reduced power consumption and improved durability.

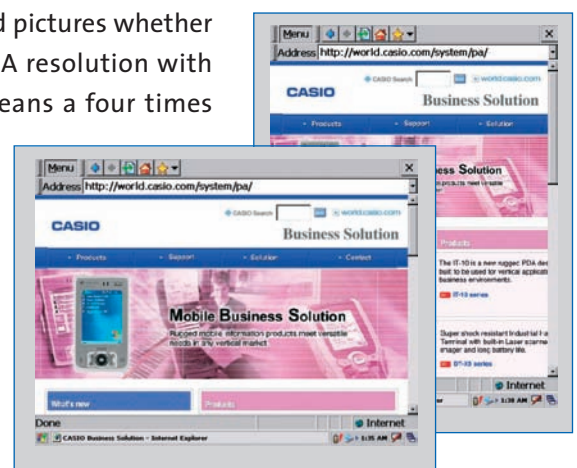

1.0 Megapixel digital camera

The 1.0 megapixel onboard camera (in certain models only) enables the recording and transmission of visual information. Pictures of products damaged during transport, pictures of merchandising or promotion activities or the product presentation in the shelves can easily be taken, stored and sent.